



Madison County Public Schools

Madison Primary School Renovation Public Hearing

November 12, 2018

SYSTEMS DEFICIENCIES AT MADISON PRIMARY SCHOOL



- **HVAC SYSTEMS**
 - Nonfunctional
 - Energy Inefficient
 - Parts Availability
 - Not Code Compliant
 - Inadequate Control
 - No Conditioning at Kitchen
- **LIGHTING**
 - Costly
 - Energy Inefficient
 - Switching
- **POWER**
 - Inadequate Propane Generator
 - Transformer and Panel Board locations
 - Inadequate Power in Classrooms
- **PLUMBING**
 - No Warm Water at Classrooms, Toilet Rooms
 - Malfunctioning Classroom Sinks
 - Inappropriate Fixtures
 - No Sinks in Some Rooms
- **FIRE ALARM**
- **SECURITY SYSTEMS**
- **DATA / TELECOMMUNICATIONS UPGRADES**
- **PA SYSTEMS / MASTERCLOCK**
- **EMERGENCY RADIO BOOSTER SYSTEM**

NECESSARY UPGRADES AT MADISON PRIMARY SCHOOL



- SECURE BUILDING ENTRANCE
- ACCESSIBILITY FOR TOILET ROOMS, STAGE
- CLASSROOM WALLS
 - Code Compliance
 - Acoustics
 - Power / Data
- TOILET ROOM LOCATIONS AND LAYOUT
 - Location of Staff Toilets
 - Student Toilet Lavatories
 - Kindergarten “Split” Toilet Rooms
 - Distraction for Adjacent Classrooms
- LOCATIONS FOR INTERVENTION SPACES
- LOCATION OF ART AND MUSIC
- ENCLOSING WALLS FOR LIBRARY AND CAFETERIA
- SCATTERED SPECIAL EDUCATION SPACES
- NO CLASSROOM FOR SPANISH INSTRUCTION
- LOST “POD” COLLABORATION SPACES
- TDT LOCATED IN MUSIC ROOM
- INADEQUATE TEACHER WORK ROOM
- INADEQUATE PRINCIPALS’ OFFICE SIZE
- WINDOW REPLACEMENT



VA DEPARTMENT OF EDUCATION GUIDELINES for SCHOOL FACILITIES DEFICIENCIES

- **CLASSROOM SIZE**
 - 975 s.f. for Pre-Kindergarten and First Grade (820 s.f. existing average)
 - 1,080 s.f. for Art, with 350 s.f. art storage (812 s.f. existing, with no separate storage)
- **CLASSROOM TOILETS**
 - Individual Toilets at Pre-K, Kindergarten, and 1st Grade
- **LIBRARY**
 - Librarian's Work Room, A/V Storage, Staff Library
- **CLINIC SIZE, EXAM ROOM**
 - No Shower
 - Not ADA Compliant
 - Not large enough for Waiting Area
- **TEACHER WORK ROOM SIZE**
- **ADMINISTRATIVE OFFICE, FINANCIAL OFFICE**







EXISTING

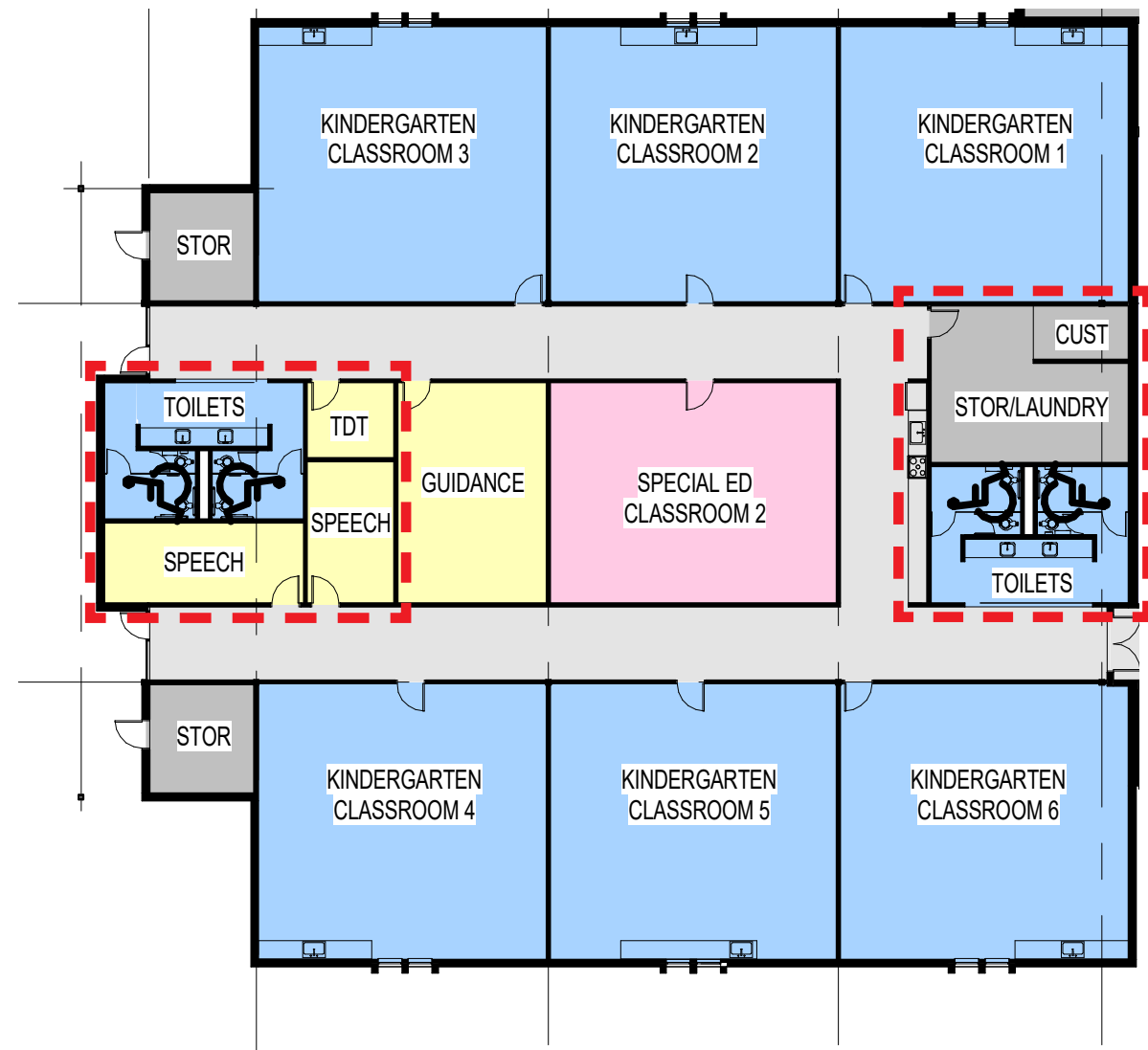

NEW

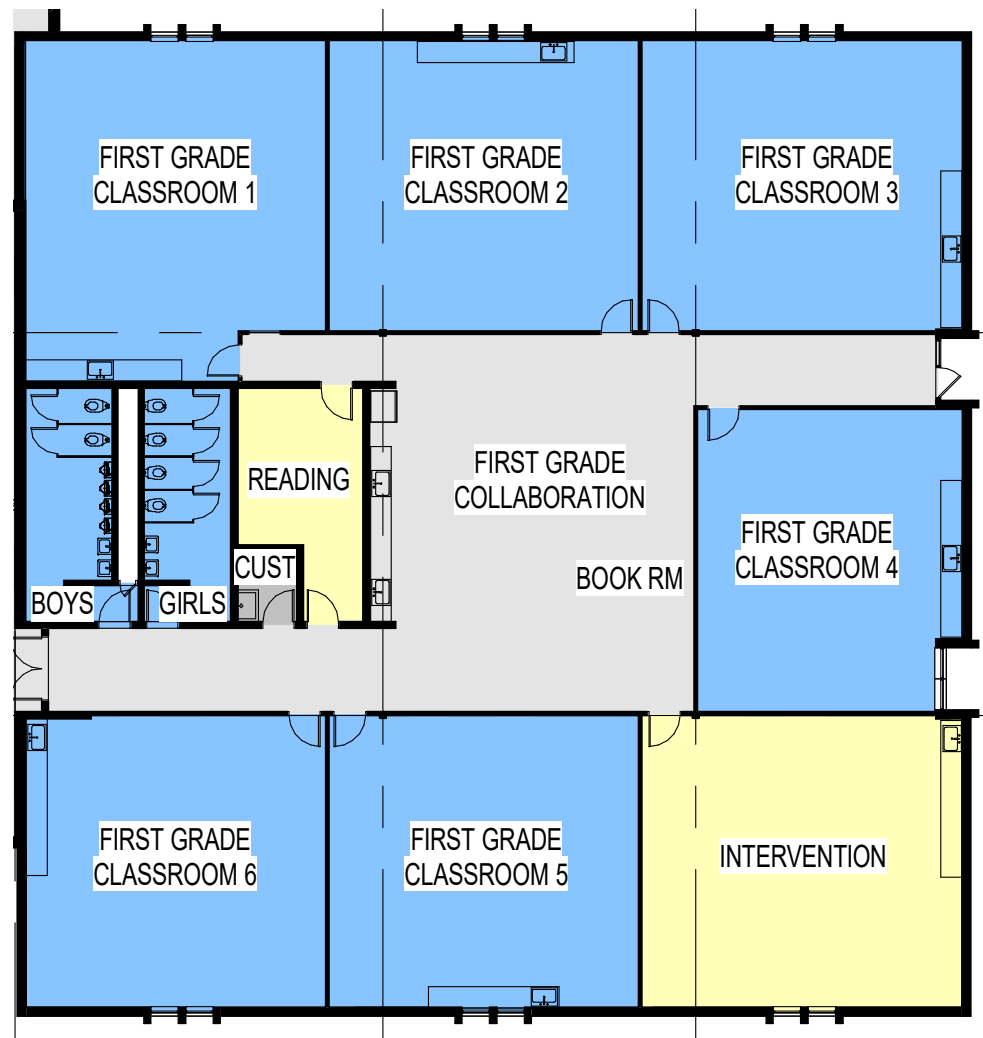

EXISTING

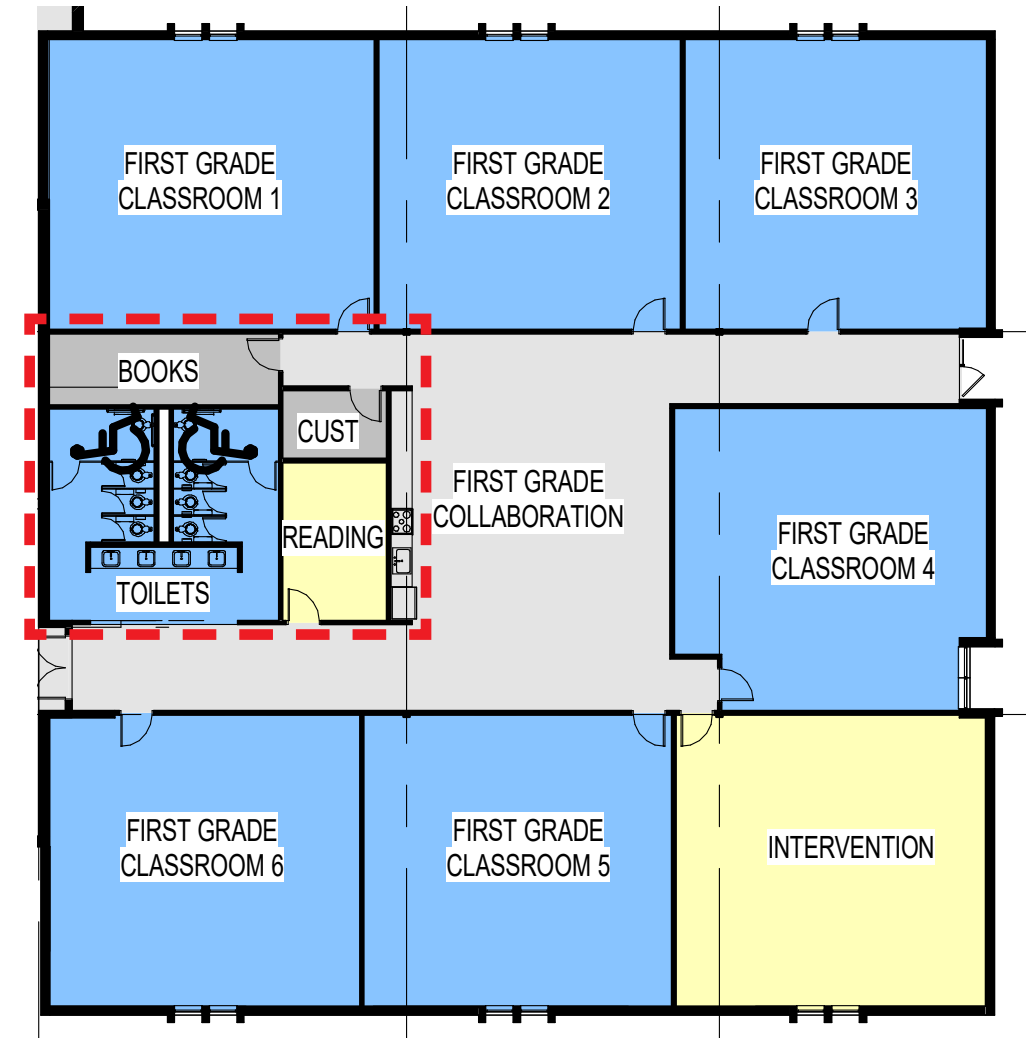

NEW

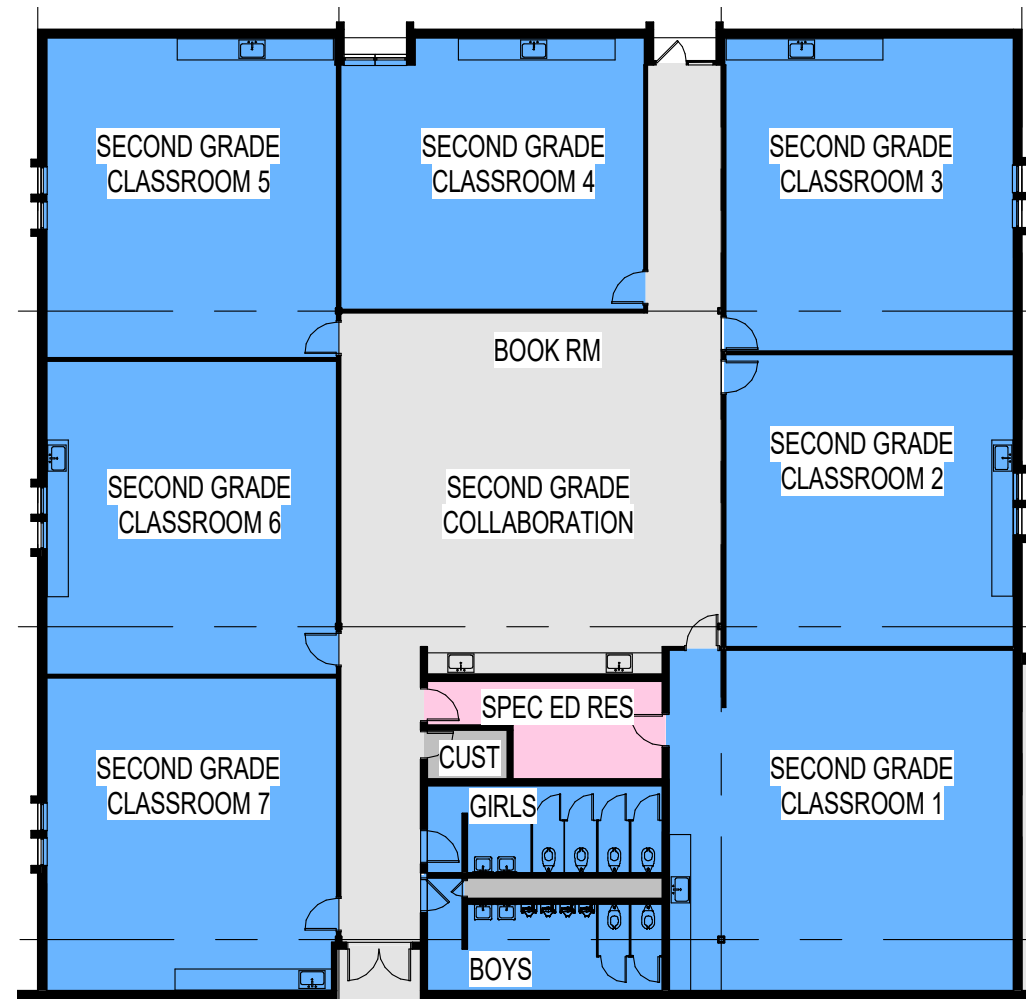

EXISTING

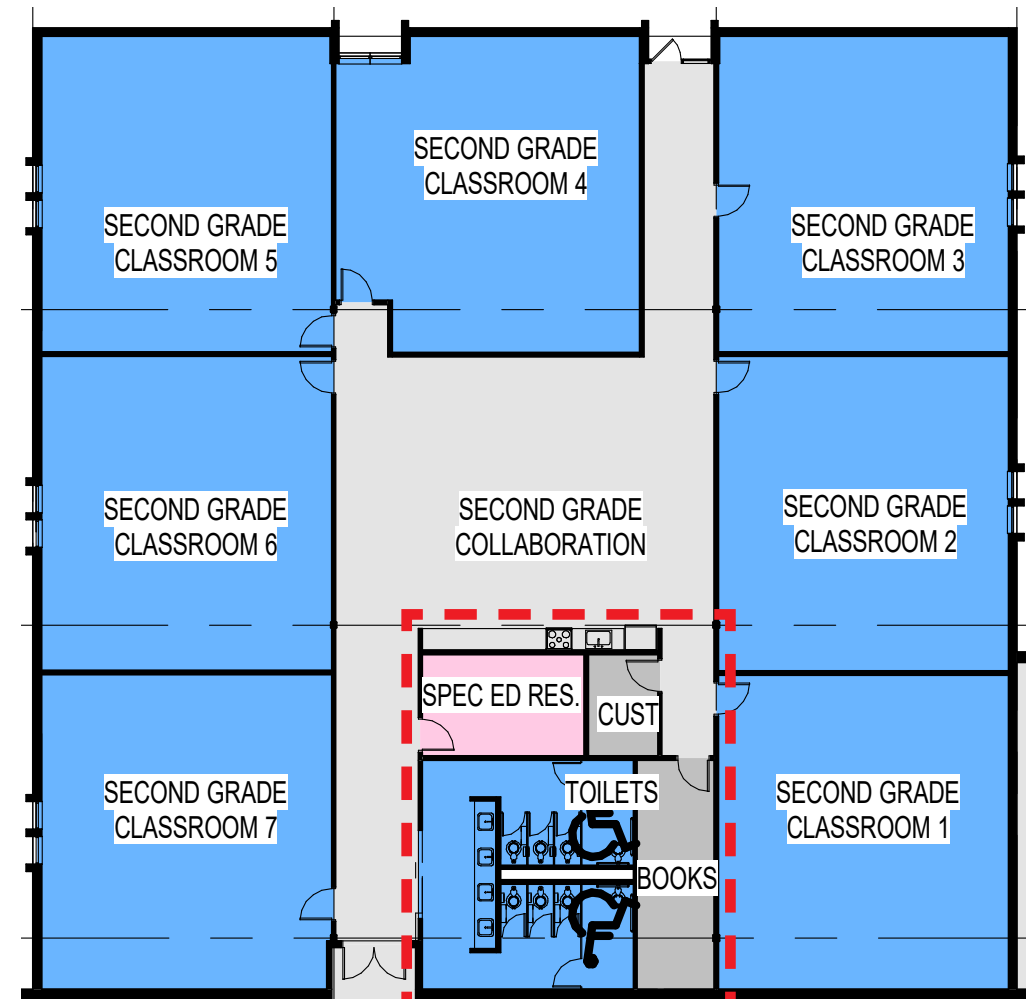

NEW

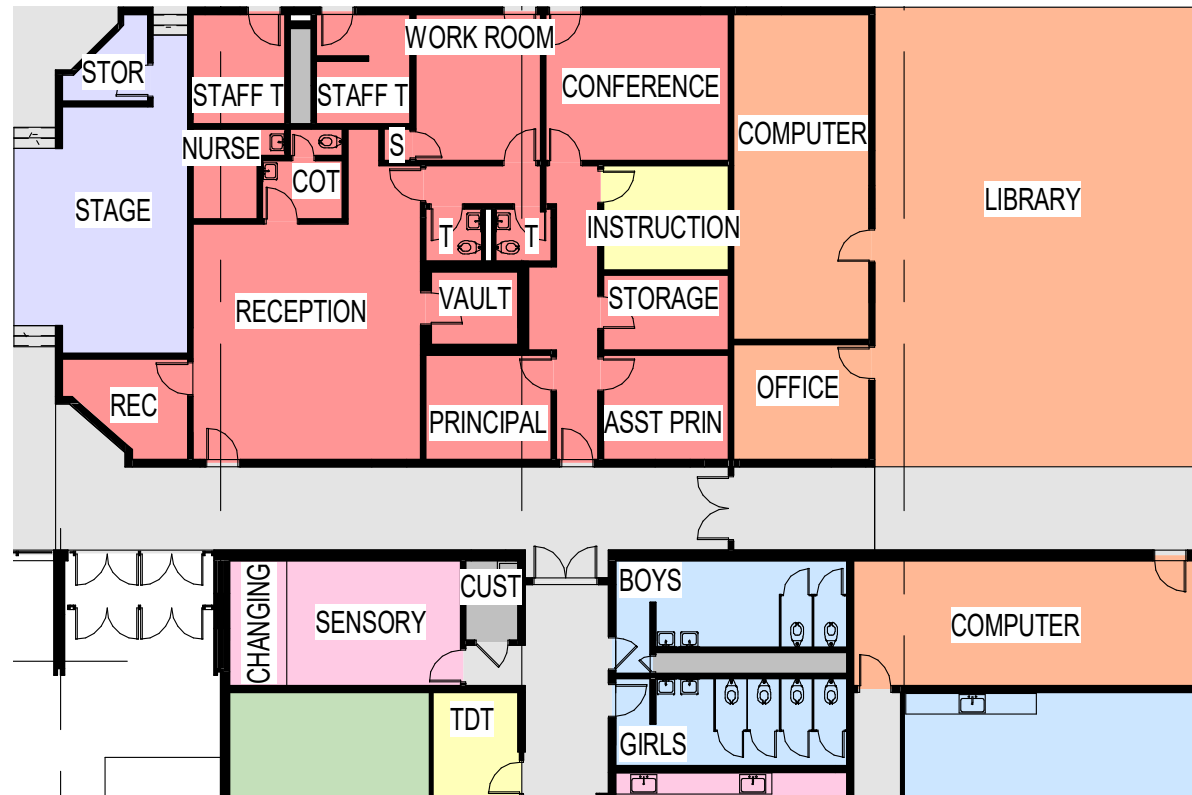

EXISTING

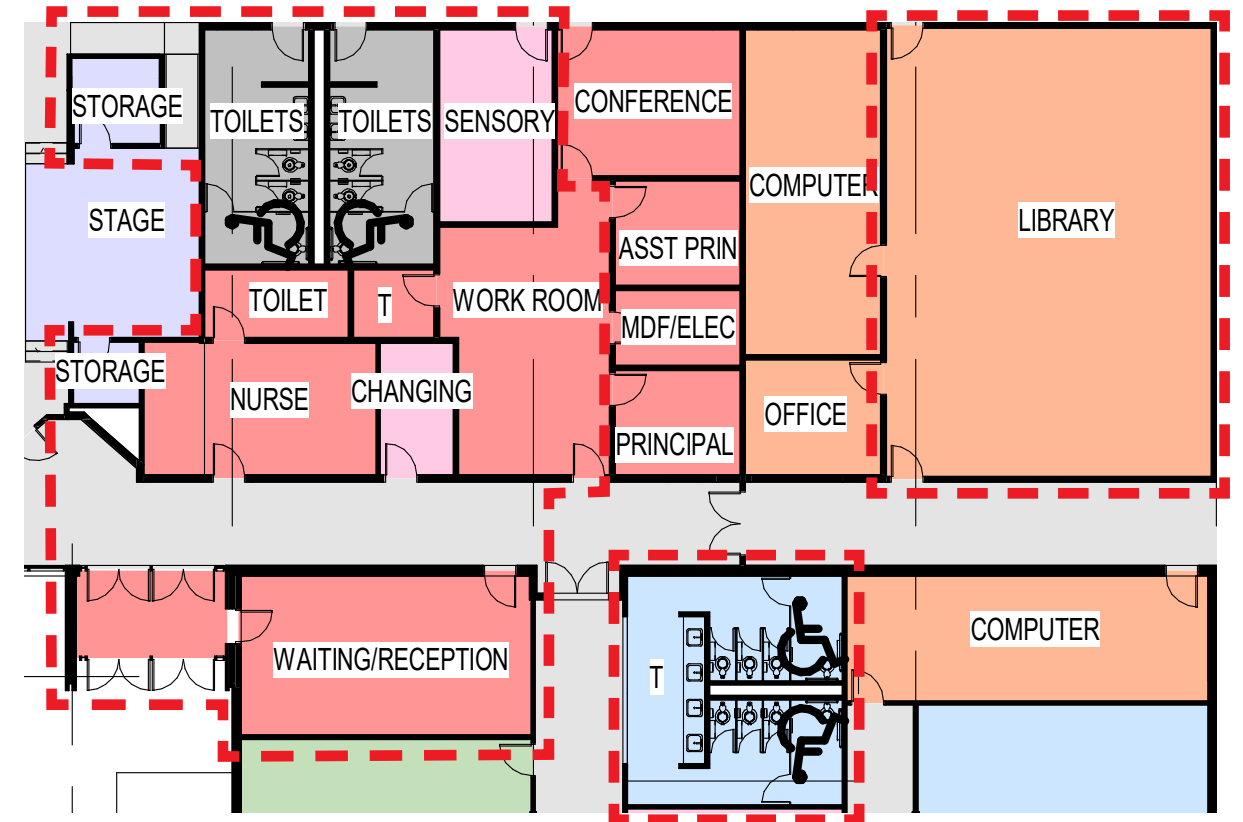

NEW





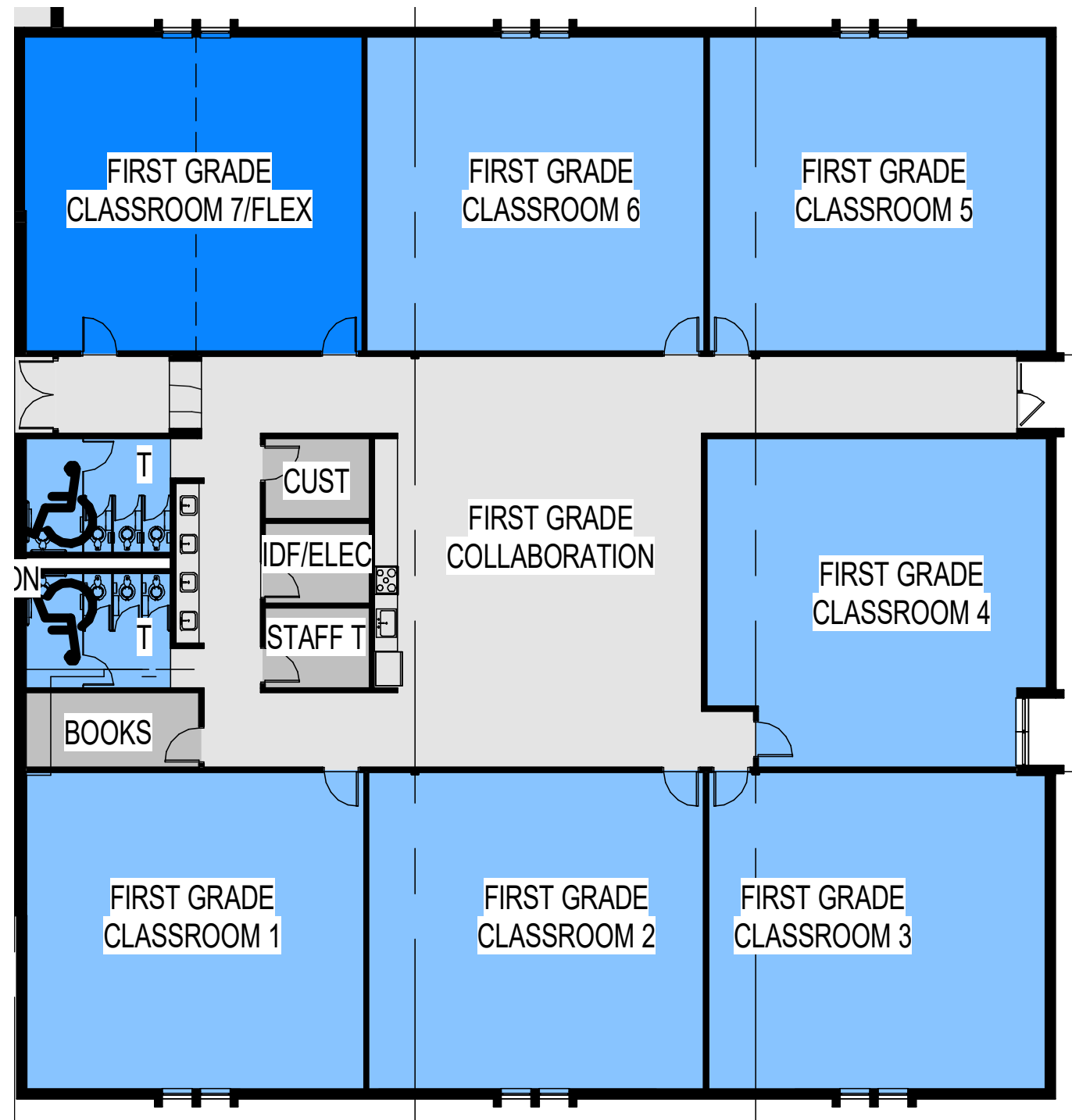

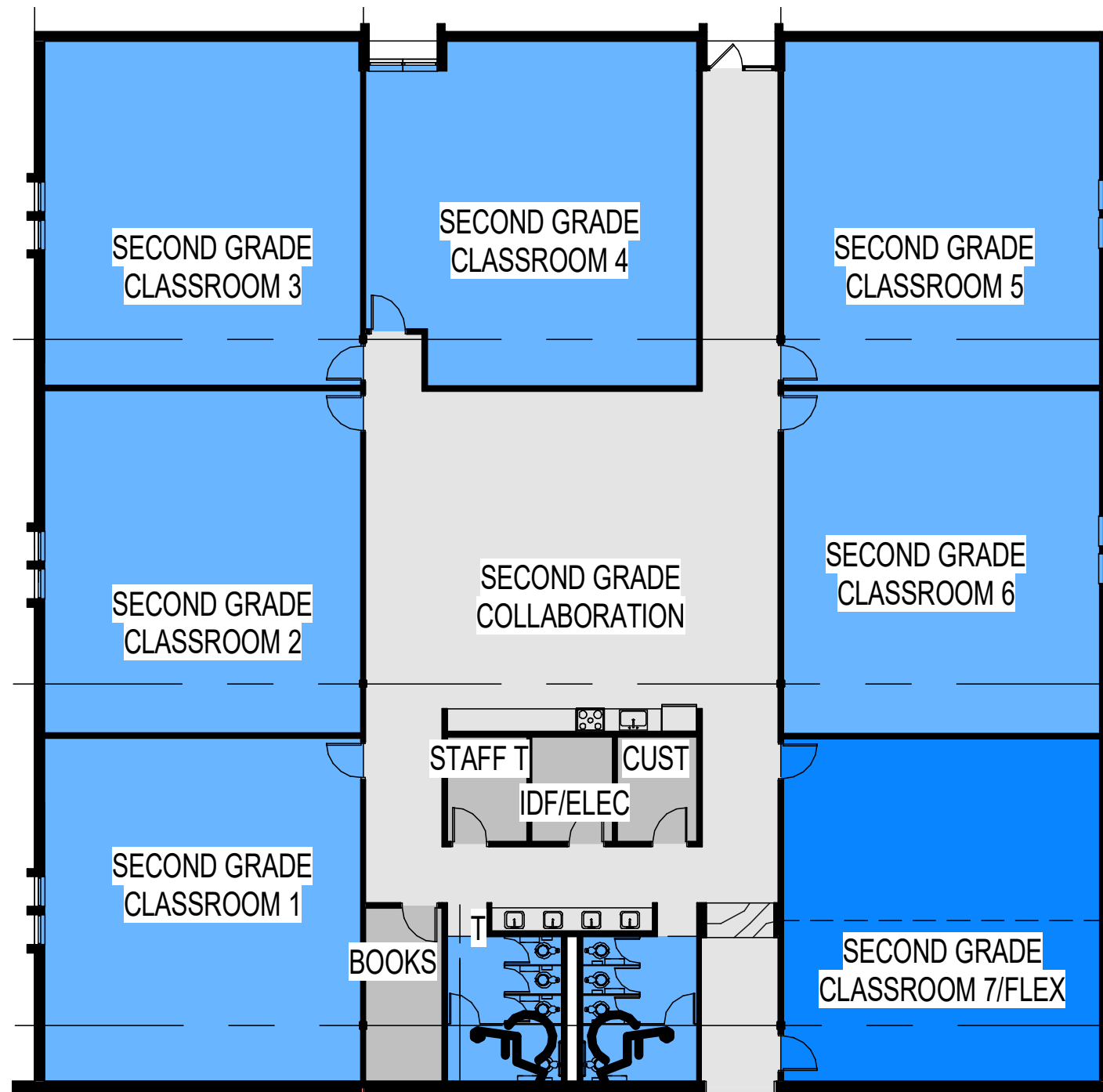

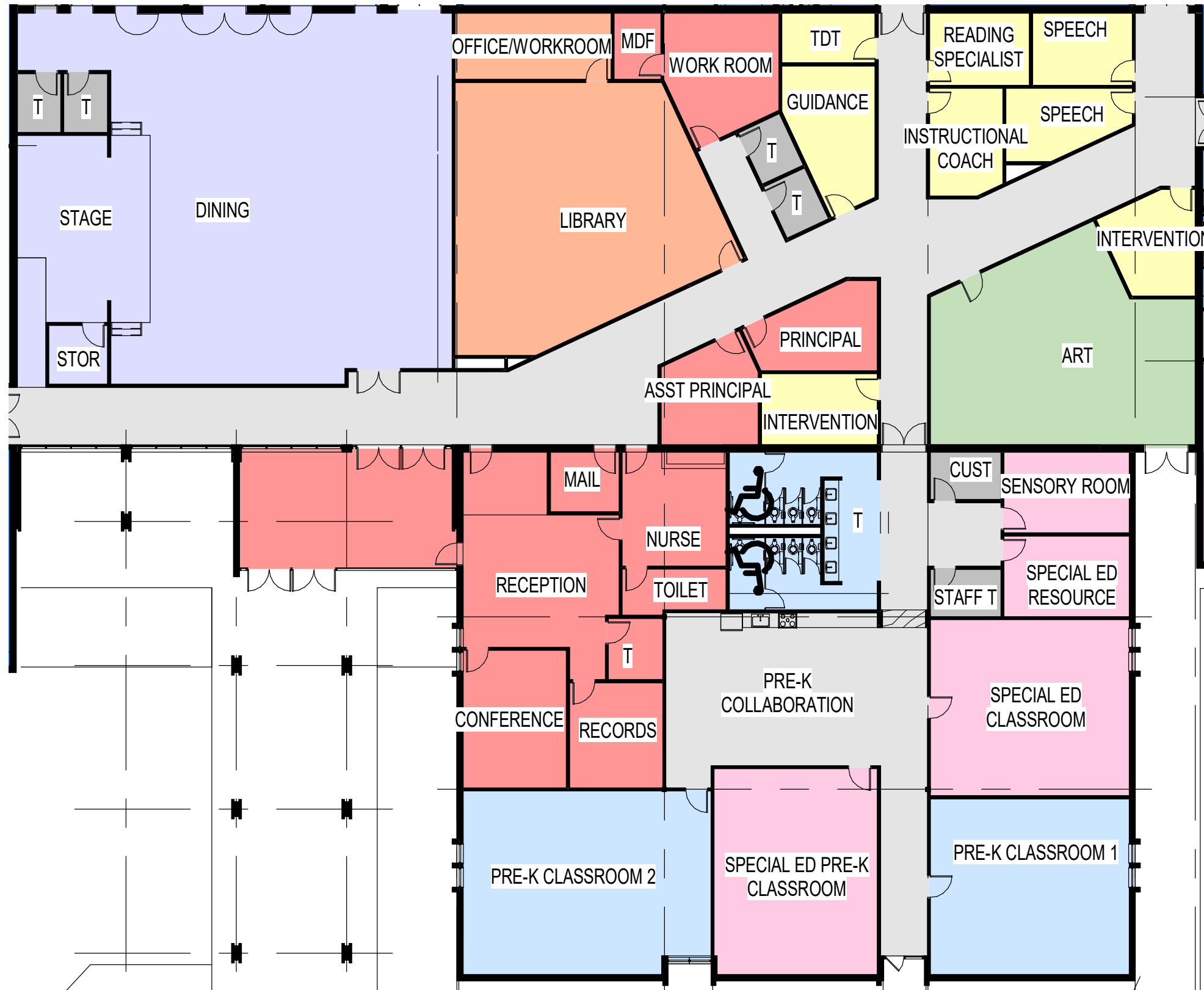





CONSTRUCTION COST

(INCLUDES ESCALATION TO MID-POINT OF CONSTRUCTION)

TIER 1	\$10.00 TO 10.75 MILLION
TIER 2	\$11.10 TO 11.75 MILLION
TIER 3	\$11.90 TO \$12.75 MILLION